

# Systemised textile weather protection

The weinor Plaza Pro offers shelter from sun, wind and rain.  
The sturdy construction is made with tried-and-tested technical components  
and is suitable for all manner of applications

[www.weinor.com](http://www.weinor.com)

**weinor**  
THE AWNING  
*... more than  
sun protection*



weinor Plaza Pro



weinor Plaza Pro

*With a combination of posts and crossbeam, this unit is extremely resistant to wind surges. At an angle of 14°, rain runs off the unit in a controlled manner. What's more, any projection length can be chosen regardless of the width. Glazing elements can be fitted as optional extras.*

## Technical details

### Max. sizes

- 1-section: housing width up to 500 cm; projection angle up to 600 cm
- Multi-section units possible

### Technical features

- The supports and crossbeam on the **weinor Plaza Pro** are based on components used in the **WeiTop Terrazza**
- The attached awning is based on the **weinor WGM** conservatory awning
- The combination of winding and guiding technology makes for quiet running (European patent no.: EP0546297)
- Service-friendly circumferential tensioning system (European patent no.: EP000000559959A3) using Tex-Seil rope, patented rope winding, integrated into drop profile and pre-tensioned
- Detachable inspection cover

- Easy to re-tension using gears housed in drop profile
- Patented carriage system for side winds (angled at up to 10°)
- Gutter integrated into drop profile
- Protective brushes prevent water entering during driving rain
- Side overhang of housing a mere 19 mm
- Intelligent coupling system for multi-section units
- Wide selection of support brackets
- Distance bars for bigger widths/lengths

### Design

- Wide selection of fabrics from weinor's latest collections

### Powder coating

- In 47 standard colours
- Surface permanently scratch- and weather-resistant
- Maintenance-free; rustproof; reliable

### Drive

- Motor as standard

### Options

#### Drive

- Wireless drive

#### Controls

- Sun and wind sensor
- Automatic rain sensor

#### Fittings

- Tempura heating system
- Lux light bar

#### Accessories

- The **weinor Plaza Pro** can be combined with glazing elements (GEs), as a parapet or entire side element
- Wall sealing profile
- Distance bar

## weinor Plaza Pro product engineering highlights



*weinor Plaza Pro*

### Little housing overhang

With its slimline housing (the side caps overhang by a mere 19 mm), the **weinor Plaza Pro** is also a suitable option in places where installation can be awkward – in niches for example.

### The end caps

These are made of high-quality cast aluminium and are an elegant way to close off the side channels. Their shape and colour are designed to match the head plate covers on the awning housing.

Other end cap colours and head plate covers available (surcharge applies).



*Gutter in drop profile*

### The gutter

Should the **weinor Plaza Pro** ever become wet during driving rain, the rainwater runs off in a controlled manner in the same way as on a pitched roof.

### The carriage system

Precision rollers dramatically reduce roll resistance. The awning opens and reacts extremely smoothly as a result (European patent no.: EP 0545062).

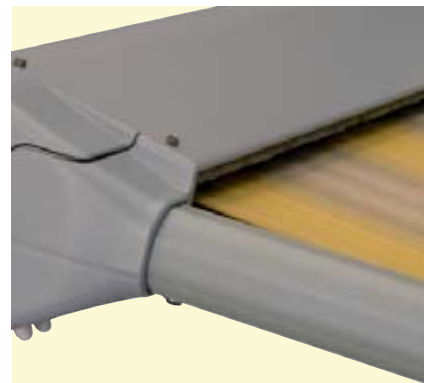

*Protective brushes in awning housing*

### Protective brushes

These prevent water entering the cassette during driving rain. They are especially effective when the **weinor Plaza Pro** is not fitted at a slope but more horizontally – at a minimum pitch of 5°, for example.



## weinor Plaza Pro product engineering highlights

---



*Open drop profile with patented tensioning system*

### **The tensioning system**

This system stands out for its easy, yet sturdy assembly. The Tex-Seil rope is the same high-tensile, tear-resistant rope found in sailing on the high seas and does not stretch. Using combined winding and guiding technology, the winding action of the rope is controlled and virtually noiseless. The tensioning mechanism is located in the drop profile, making it freely accessible and easy to service.



*Rope drum and glider (patented)*

The fabric can be easily tensioned using an Allen key. The ingenious mechanics ensure that the fabric remains taut at all times (patent pending under P 4207821.0).



*Fabric tension easy to control*

## weiner Plaza Pro product engineering highlights



*The fabric is stretched over the crossbeam*



*Strengthening profile on guide rail*



*weiner Plaza Pro with GE as parapet between the posts*

### Crossbeams and posts

The sturdy crossbeams and supports make the unit extremely resistant to wind surges. Stretching the fabric over the crossbeam gives the **weiner Plaza Pro** its exceptional fabric tension. The appearance of streaks on the fabric in this area can be reduced by selecting an appropriate fabric design.

The free-standing structure means the house wall is subjected to less stress load than is the case with other types of awning (e.g. folding arm awnings), and when pitched at 14° water runs off in a controlled manner.

### The awning

The **weiner Plaza Pro** awning is a well-engineered product, having been based on the tried-and-tested **WGM 2020**.

### The strengthening profile

The side guide rails are reinforced through the inclusion of the strengthening profile. A gutter has been incorporated into the strengthening profile. The addition of a side stop means that it is also possible to fit GEs or vertical sun protection as optional extras.

### Strengthening profile/guttering section

Strengthening profile are automatically supplied on projection lengths of 4 m and above. On multi-section units, a guttering section is fitted to the strengthening profiles in the vicinity of the coupling joint.

### Glazing elements (GEs)

The **weiner Plaza Pro** can be combined with weiner GEs, by fitting them either between the posts or to the stop on the strengthening profile, including to the sides. The unit is then entirely encased; alternatively, the GEs can be used as parapet elements.

## weinor Plaza Pro multi-section units

### The multi-section unit

A multi-section unit is a series of individual units fitted side by side, each one of which has its own motor drive. This enables different projection lengths to be selected per unit. The side channels rest on the shared crossbeam. On multi-section units, the stiffeners come ready supplied with gap cover plates.

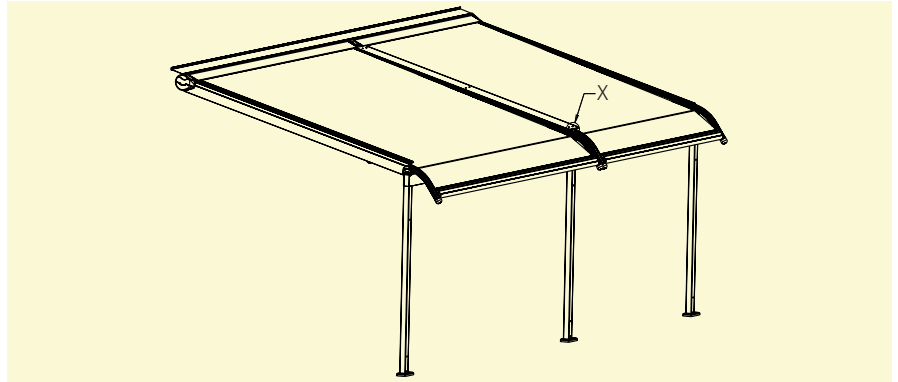

weinor Plaza Pro multi-section unit

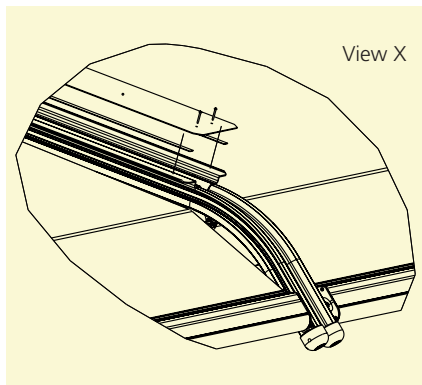

Guttering section on strengthening profile

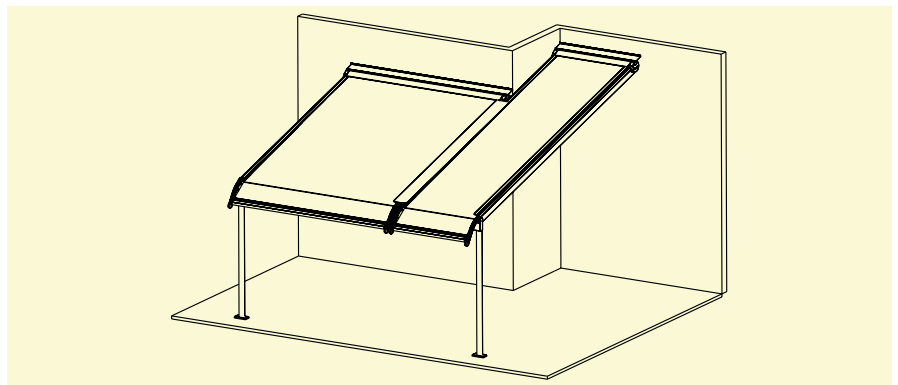

Multi-section unit with wall offset

### Options

A variety of offset versions (e.g. wall offset) can be designed on request.

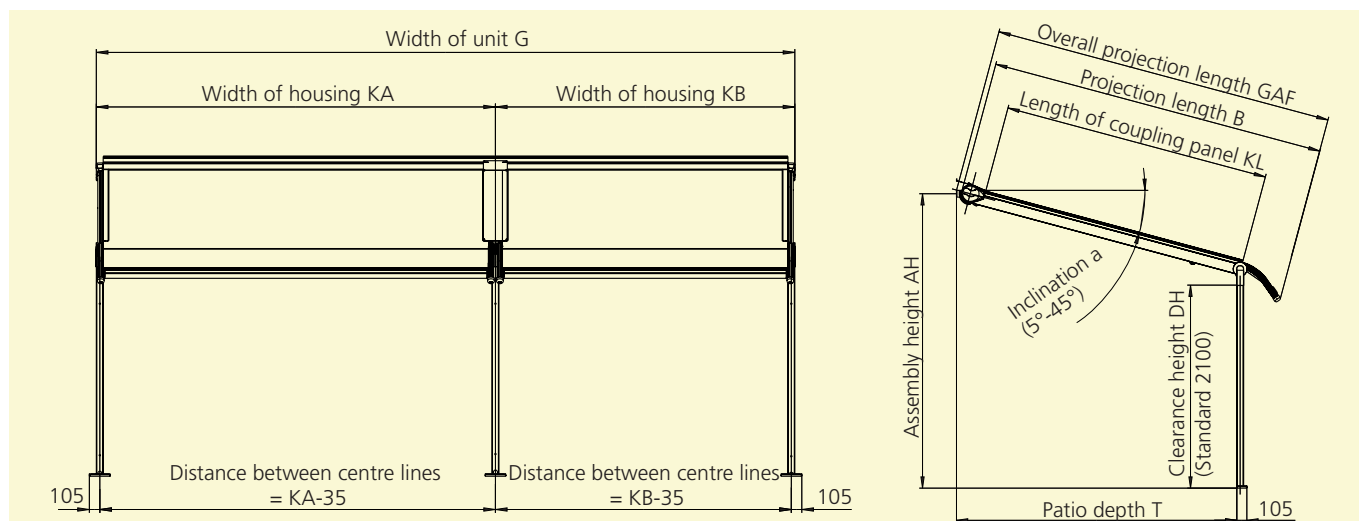

Outside measurements of coupled units without offset

## Product benefits at a glance

| Designation   | Material  | Surface treatment                      | Qualities  | Your advantages  |
|---|---|--|--|--|
| Housing profile<br>Drop profile<br>Guide profile<br>Support bar<br>Post<br>Crossbeam<br>Strengthening profile | Extruded aluminium  | Chrome-free pre-treated, powder-coated | Surface permanently scratch- and weather-resistant | You choose which powder coating should be used on your <b>weinor Plaza Pro</b> to match your house. Pre-treating the profiles in this way prevents any corrosion arising, even if the surface becomes damaged. |
| Elbow   | Extruded aluminium  | Chrome-free pre-treated, powder-coated | Surface permanently scratch- and weather-resistant | Reliable function thanks to rope retainer guide in the elbow area.   |
| Rope in tensioning system   | Tex-Seil rope as used in sailing on the high seas                 |  |  | Sturdy, high-tensile, tear-resistant, quiet  |
| Patented tensioning system  | With angular gear for re-tensioning                               |  |  | Easily accessible; adjustable at any time  |
| Patented winding and guiding technology   | Rope drum: high-grade plastic<br>Glider: plastic; stainless steel |  |  | Controlled, quiet winding  |
| Gutter in drop profile  | Extruded aluminium  | Chrome-free pre-treated, powder-coated | Surface permanently scratch- and weather-resistant | Rainwater in the gutter can drain off to the side.   |
| Housing and drop profile end caps   | Plastic<br>Cast aluminium   | Powder-coated                          | Surface permanently weather-resistant              | Choose the end cap colours to match the fabric or go for tone in tone.   |
| Screws/bolts  | Stainless steel   |  | Rustproof  | No rust; no appreciable wear and tear  |
| Drive motor   |   |  | Precisely engineered, sturdy design                | An electric tubular motor integrated into the fabric roller opens and retracts the awning and is operated via a wall switch, for example   |

## Product benefits at a glance

| Designation                                     | Material             | Surface treatment  | Qualities   | Your advantages   |
|---|----------------------|--|---|---|
| Awning fabric from the weinor fabric collection | Acrylic              | Spinneret dyed; high-clean nano-coating  | UV-resistant; dirt- and oil-repellent   | High colour fastness; clean fabric  |
|   | Polyester            | Spinneret dyed; high-clean nano-coating; polyester yarn; innovative weaving pattern                              | UV-resistant; dirt- and oil-repellent; very good recovery properties  | High colour fastness; clean fabric; very good coiling properties; good fabric positioning   |
|   | Waterproof polyester | Spinneret dyed; high-clean nano-coating; polyester yarn; innovative weaving pattern; special water-tight coating | UV-resistant; dirt- and oil-repellent; very good recovery properties; withstands 1000 mm of water column; glued inner seams as standard | High colour fastness; clean fabric; very good coiling properties; good fabric positioning; withstands constant rain; suitable as a rain protection unit |

## Product options at a glance

| Designation                            | Material                  | Surface treatment                      | Qualities  | Your advantages   |
|--|---------------------------|--|--|---|
| Awning fabric from external collection | Acrylic                   | Spinneret dyed; impregnated            | UV-resistant                                       | Even greater selection of single-colour and striped fabrics.  |
|  | Soltis®                   | Specially coated polyester fibre       | Microvented; light-permeable                       | Light-permeable, air-permeable sun protection   |
| Wireless drive                         |                           |  |  | On request, the integrated tubular motor can also be fitted with a <b>WeiTronic wireless receiver</b> . The awning can then be operated through the convenience of a <b>WeiTronic Remoto</b> hand-held transmitter. See section on WeiTronic for details. |
| Tempura heating system                 | Corrosion-proof materials | Chrome-free pre-treated, powder-coated | Splash-proof; for use indoors and outdoors         | Well-engineered quality, precise and weather resistant down to the last detail. Use of same components makes for easier service.  |
| Light bar                              | Extruded aluminium        | Chrome-free pre-treated, powder-coated | Surface permanently scratch- and weather-resistant | weinor's light bars Lux and Lux Design can be ordered together with the awnings. See Accessories section for details.   |



## Exploded drawing of the weinor Plaza Pro

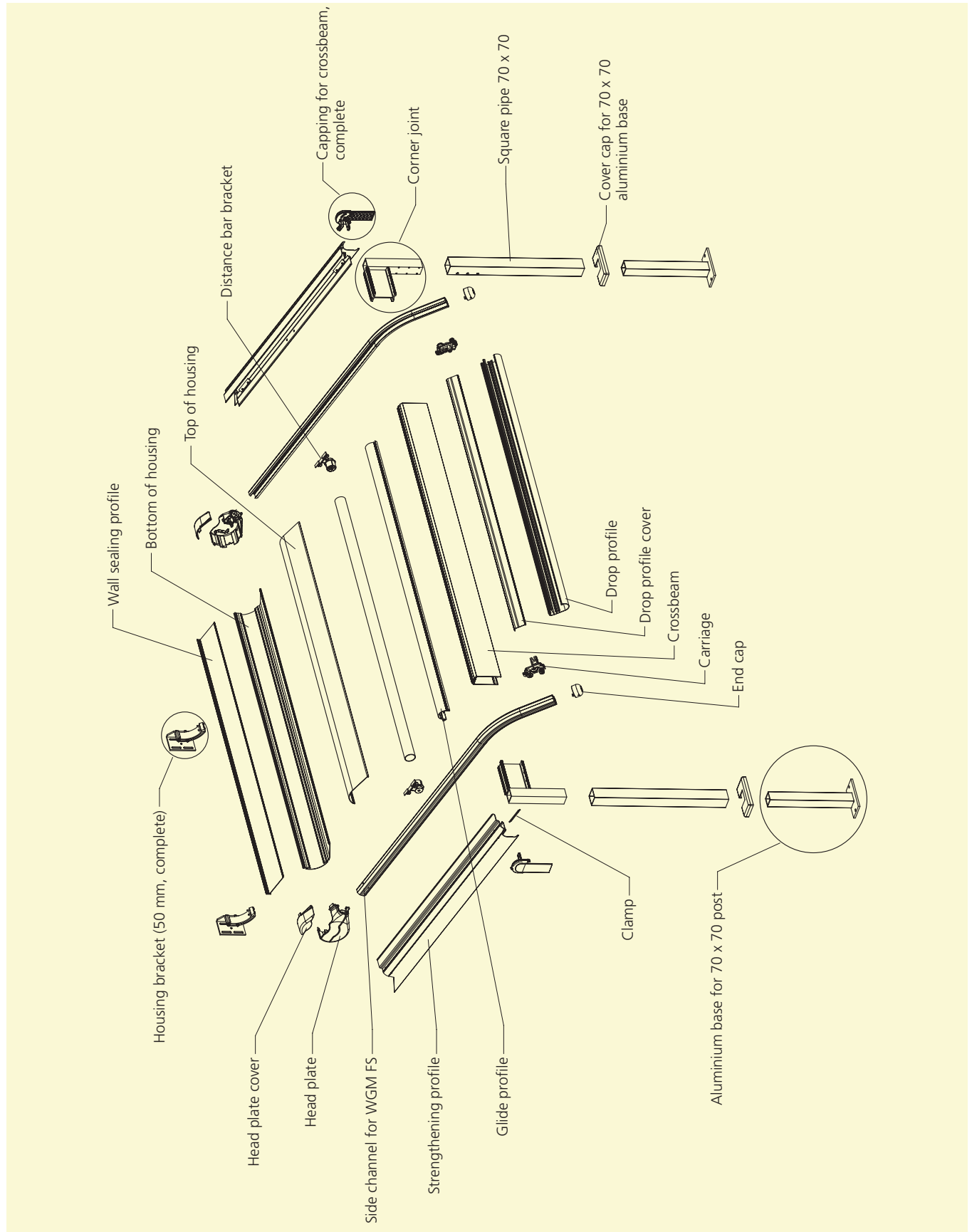

**Cross-section of weinor Plaza Pro – not to scale**

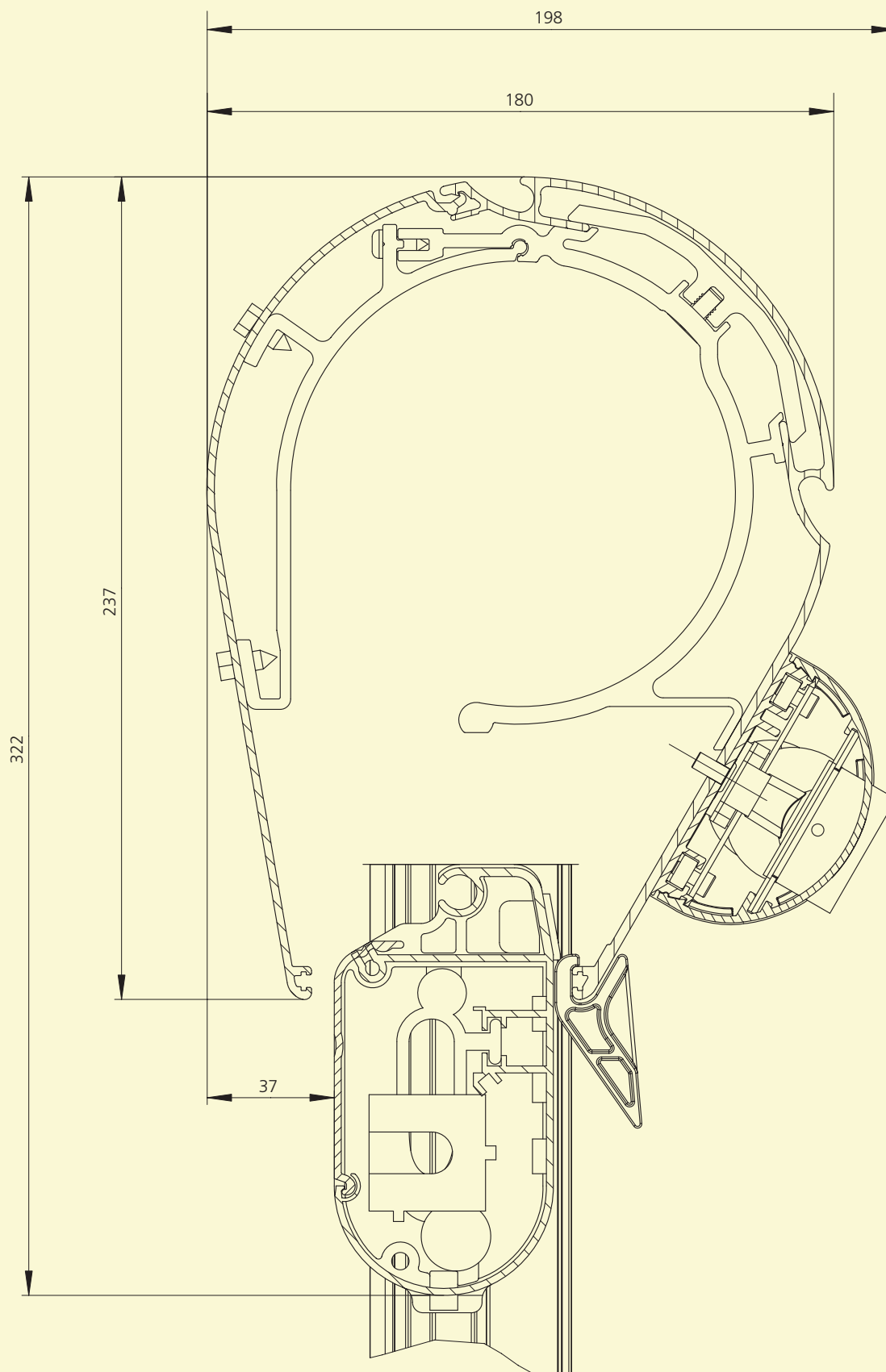

## Functional drawing of weinor Plaza Pro single-section flat unit

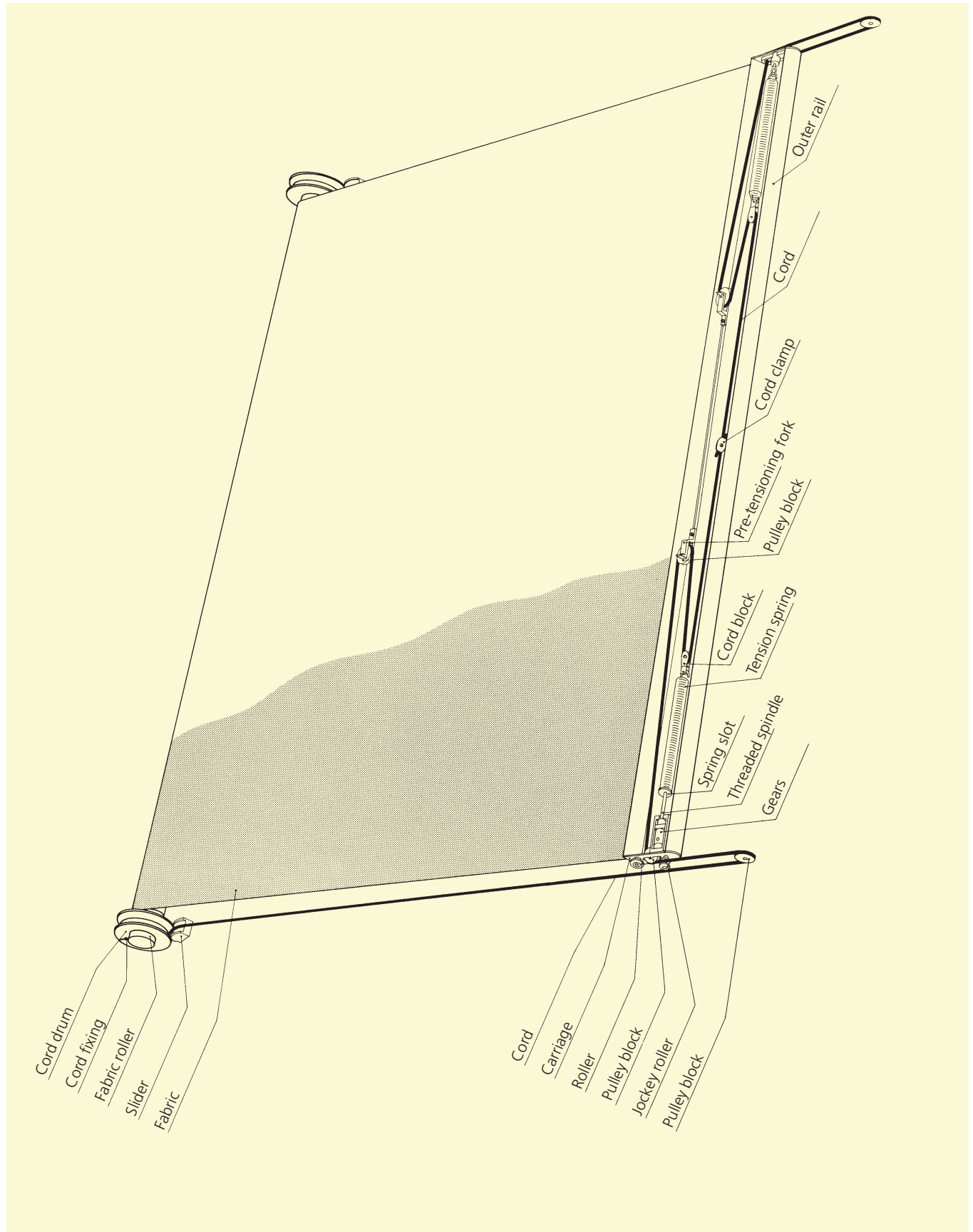

## General views

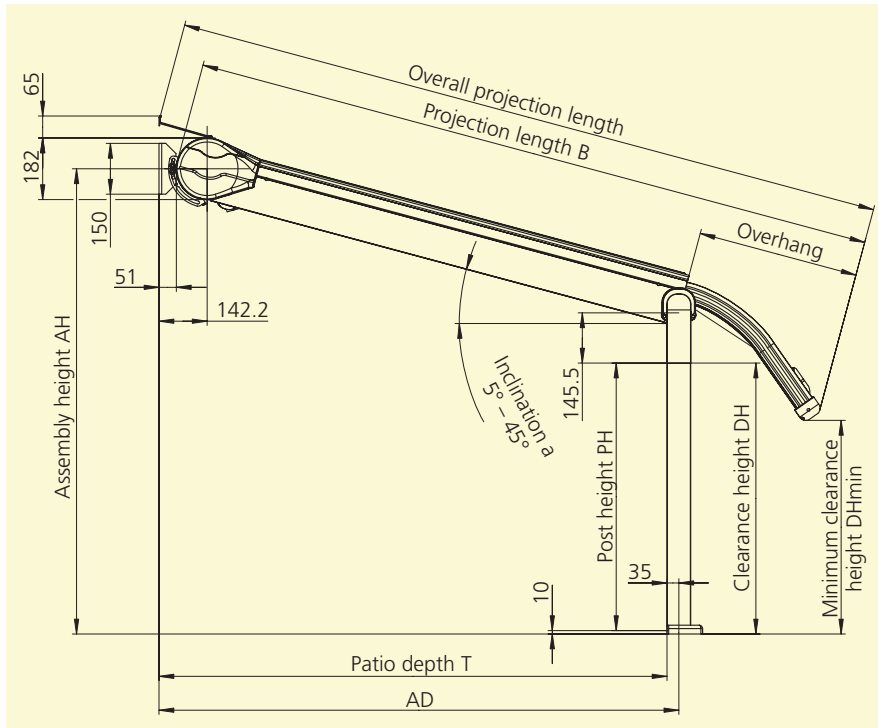

Side view of weinor Plaza Pro

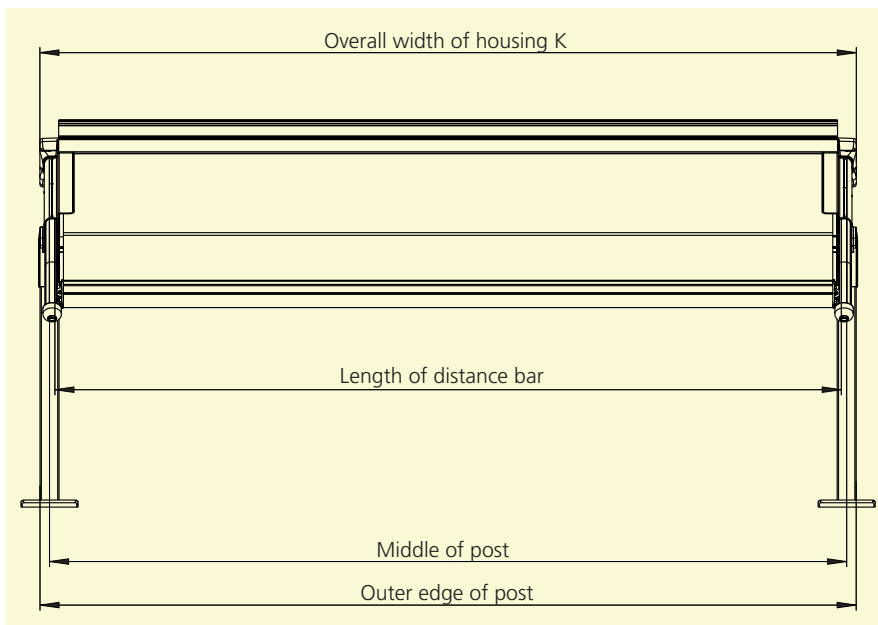

Front view of weinor Plaza Pro

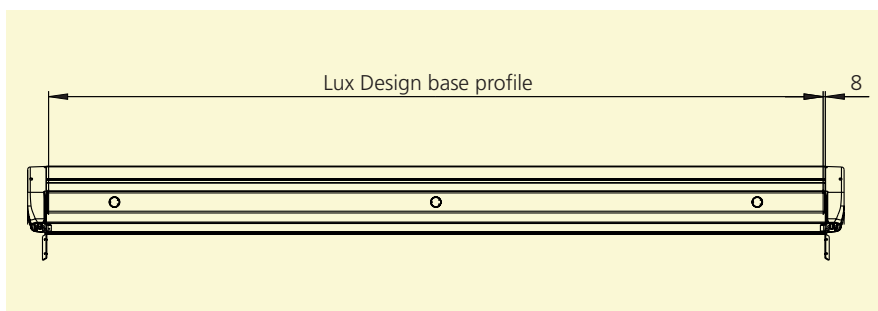

View from below weinor Plaza Pro with Lux Design light bar

## Clearance height

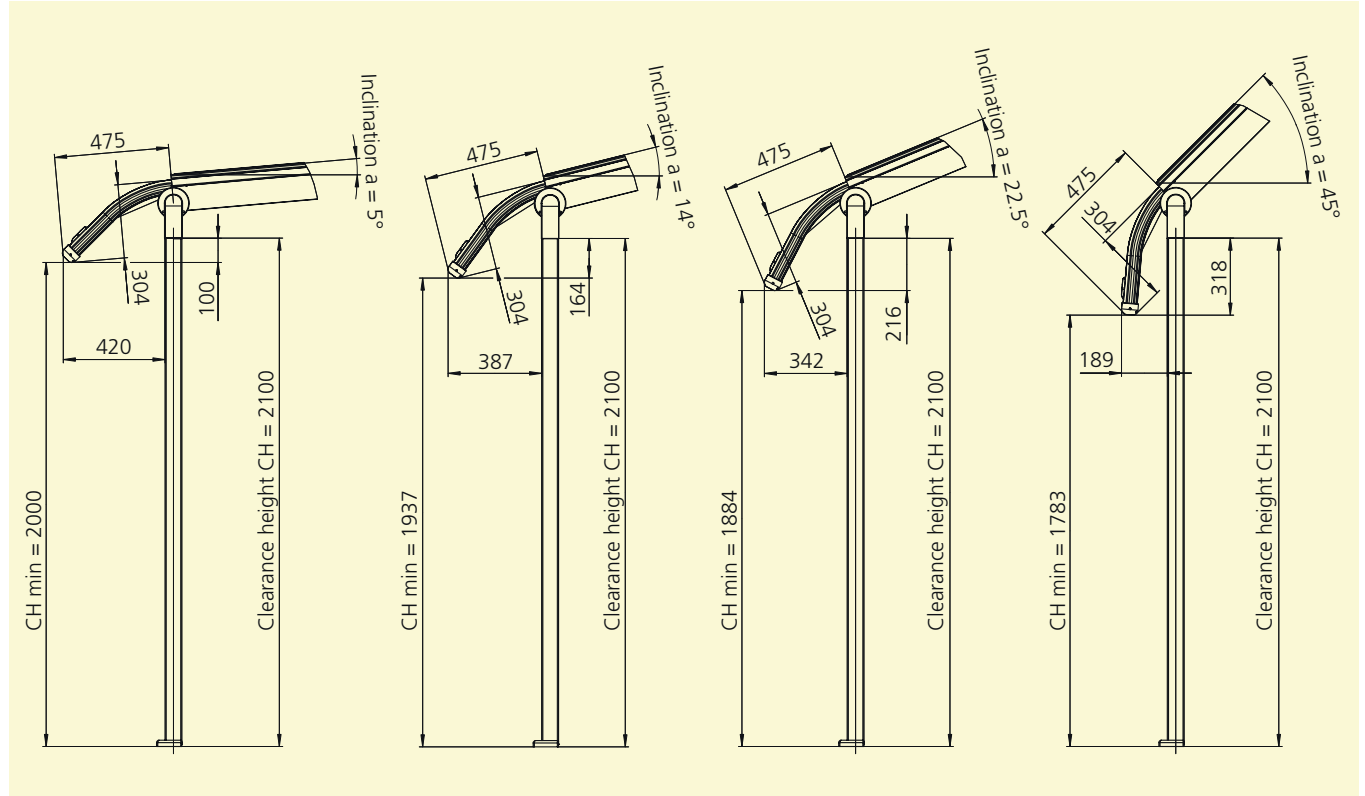

Diagram showing the minimum clearance heights on the side channels depending on the inclination.



## Glazing elements (GEs) for weinor Plaza Pro

The **weinor Plaza Pro** can be combined with glazing elements – fitted both between the posts and at the sides.

### GEs between posts

The following GE profiles can be used in this case:

w26-c (as an all-glass sliding door)

w40-c (as a folding partition)

w50-c (as fixed glazing, window, door, PTS and parapet)

### GEs at sides

The following GE profiles can be used in this case:

w50-c (as fixed glazing, window, door, PTS and parapet)

A permanent trapezium element is fitted below the strengthening profile and above the side GEs. Other customised versions on request.

### The strengthening profile

The stop makes it possible to fit the GEs at the sides of the **weinor Plaza Pro**.

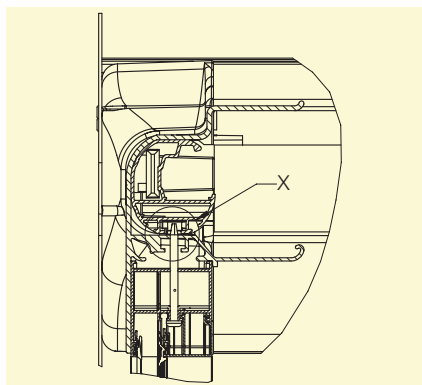

Strengthening profile

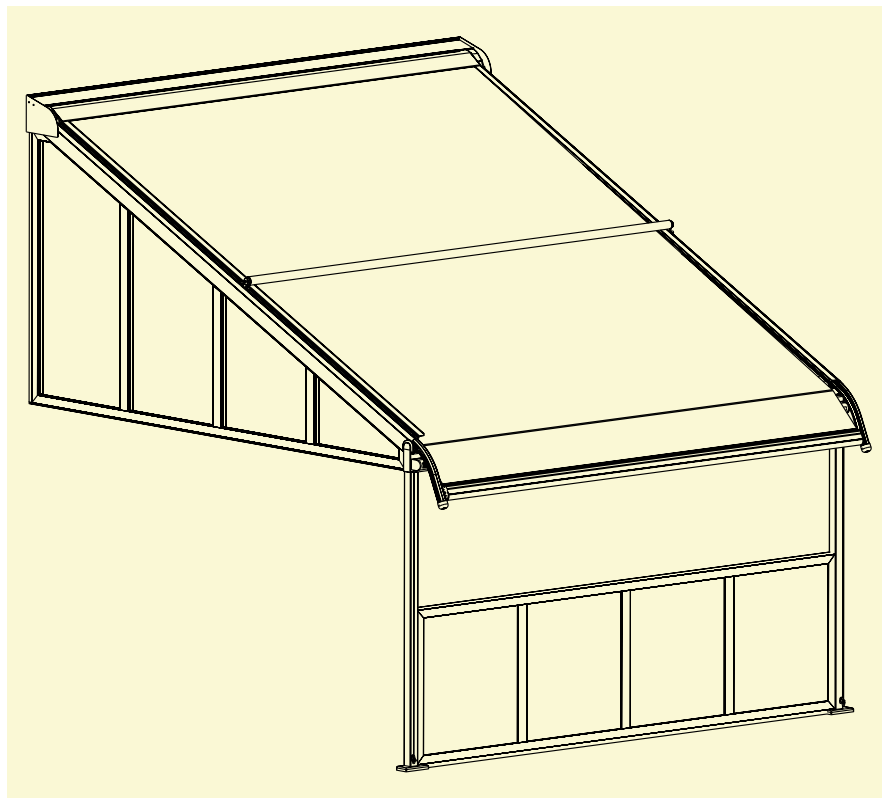

**weinor Plaza Pro** with trapezium element and parapet between the posts

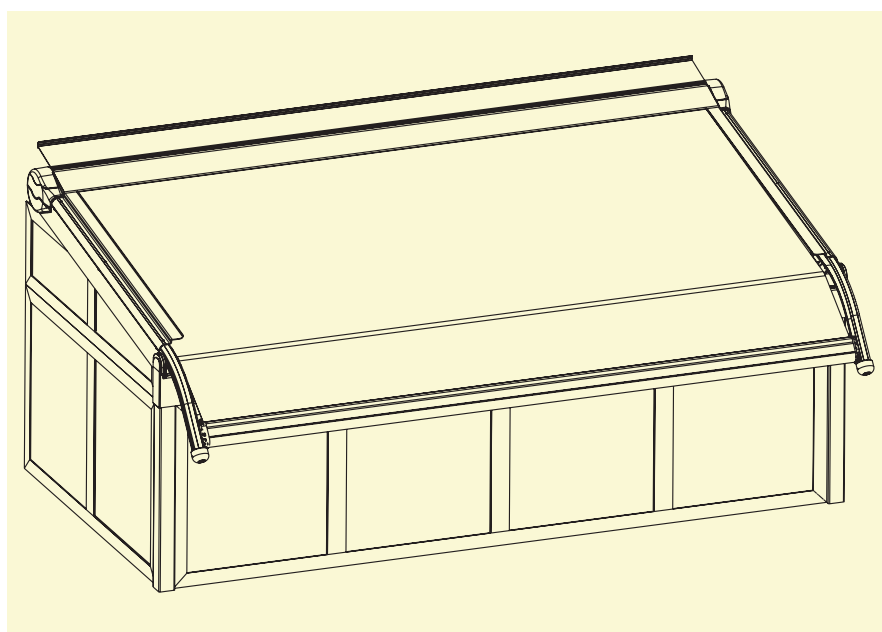

**weinor Plaza Pro** with GEs at the sides and between the posts

## Fixings (wall assembly)

### The housing bracket

The sturdy aluminium housing bracket enables the **weinor Plaza Pro** to be fitted at a roof pitch of between five and forty-five degrees. The two M8 x 70 stainless steel screws provide the necessary grip force per bracket.

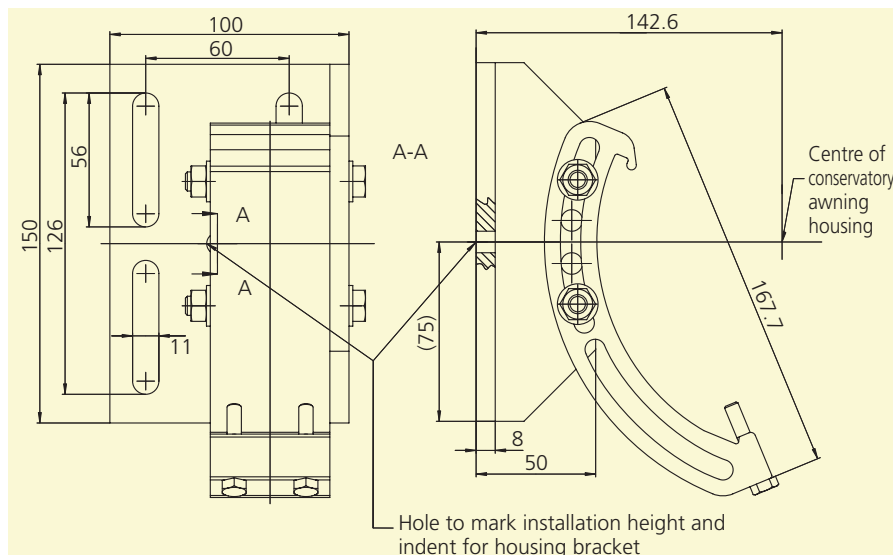

weinor Plaza Pro housing bracket

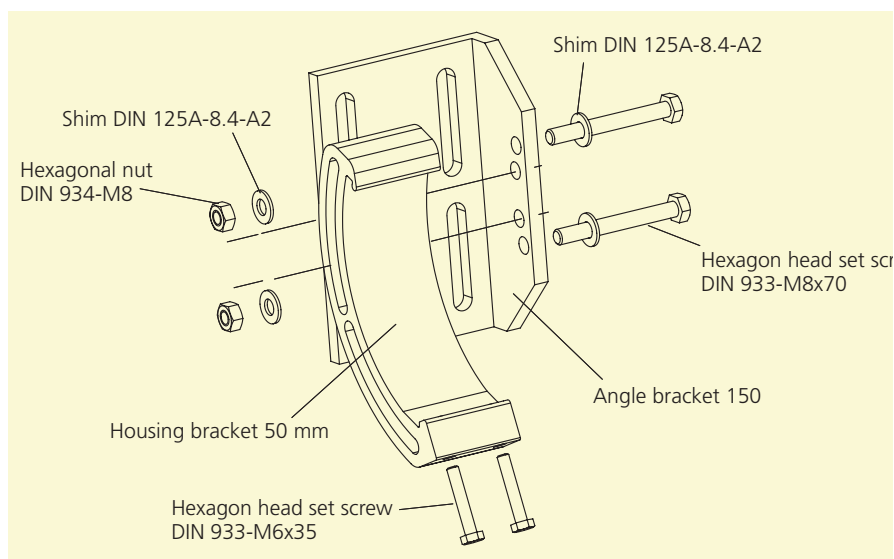

weinor Plaza Pro housing bracket

## General notes

In areas exposed to gusty winds and on larger units, etc. we recommend that you add further posts below the strengthening profile.

**i** Please note that, no matter how perfect or what high-quality materials have been used, **weinor Plaza Pro** units remain sun protection units that ensure that water will drain off in a controlled manner when positioned at an angle of 14°.

### Scope of delivery:

- Units with Soltis® fabrics can only be supplied in certain sizes.
- Motor drive without switch, plug, Hirschmann coupling as standard
- Fixings needed for structure not included

## Installation options (ceiling bracket)

### The ceiling bracket

Installation is also possible below or above a protruding ceiling, such as a balcony for example. The ceiling bracket (which is the same colour as the awning) makes installation on every configuration easy.

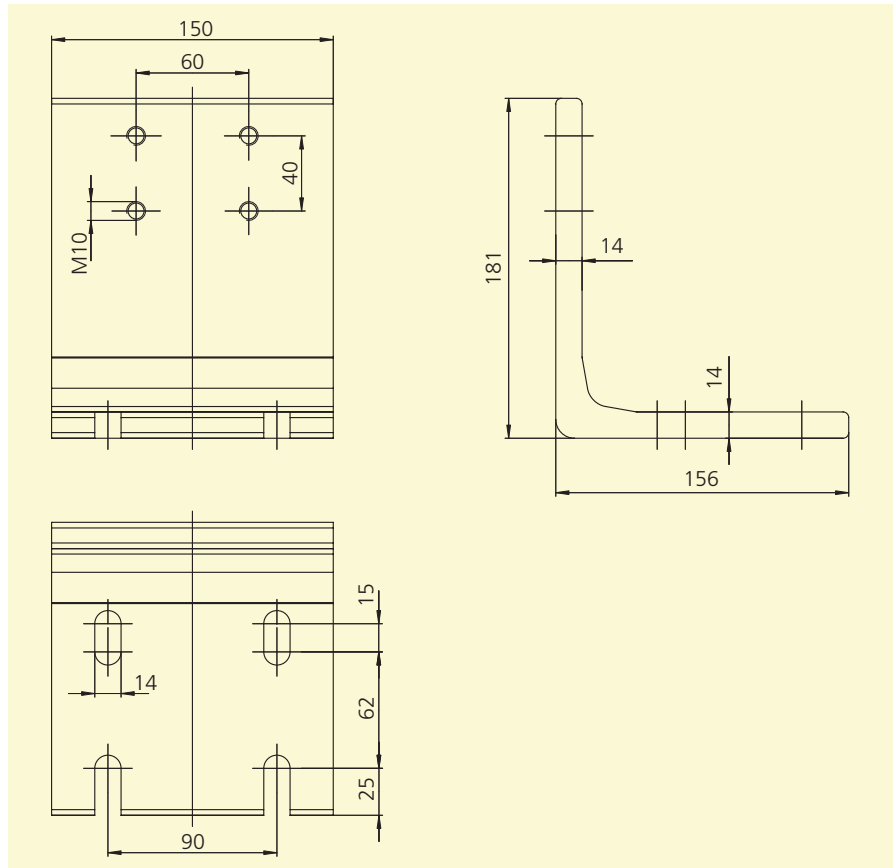

**weinor Plaza Pro ceiling bracket**

Ceiling bracket attached above the conservatory awning

Ceiling bracket for conservatory awning

Housing bracket (50 mm, complete)

DIN 933-M10x25 hexagonal bolt

DIN 125A-10.5x20x1 shim

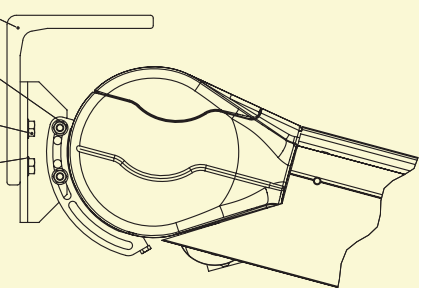

Ceiling bracket attached below the conservatory awning

Housing bracket (50 mm, complete)

DIN 933-M10x25 hexagonal bolt

DIN 125A-10.5x20x1 shim

Ceiling bracket for conservatory awning

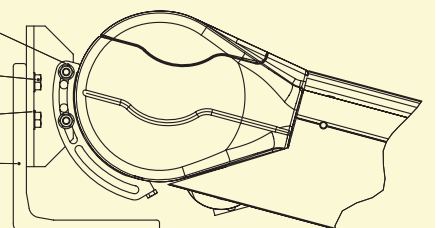

Installation options for ceiling bracket (bill of quantities)

## Distance bars (optional)

Distance bars are supplied as optional extras on customer request. If glazing elements (GEs) are used, the distance bars are fitted onto the strengthening profiles.

The distance bars can be affixed above or below the awning fabric.

ric. If the projection length is at least four metres, we recommend fitting a distance bar below the fabric to prevent the fabric from sagging heavily when wet. The appearance of streaks at the point where the fabric and distance bar touch can be reduced

by selecting an appropriate fabric design.

If trapezium glazing elements are used, the distance bars are fitted to the gutters on the strengthening profiles. The top distance bar is screwed directly onto the strengthening profile.

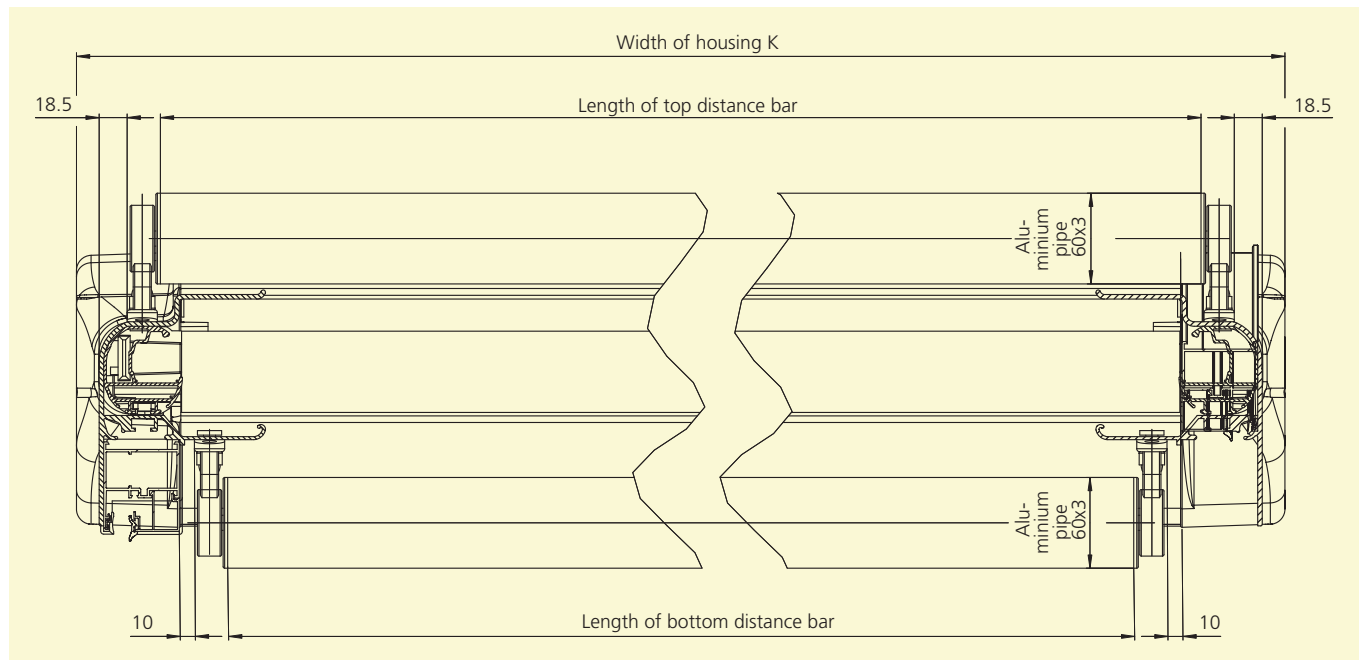

### Using a distance bar on a strengthening profile

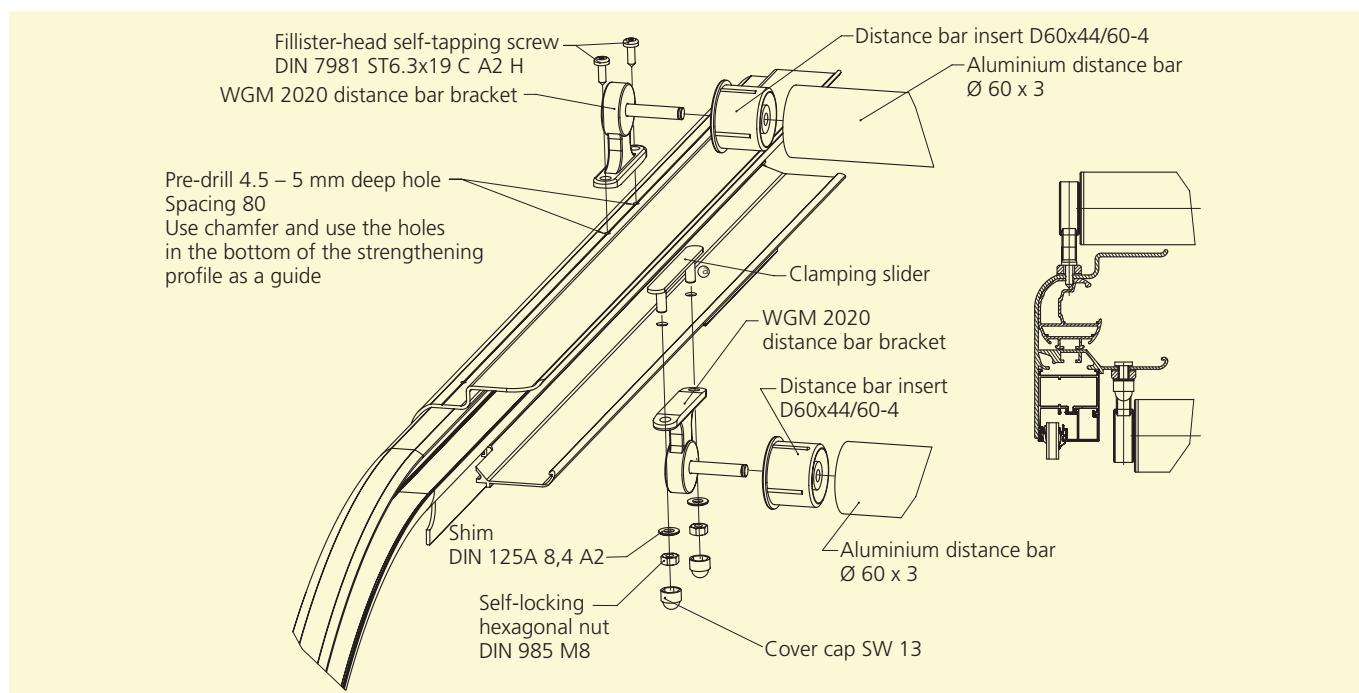

## Wall sealing profile

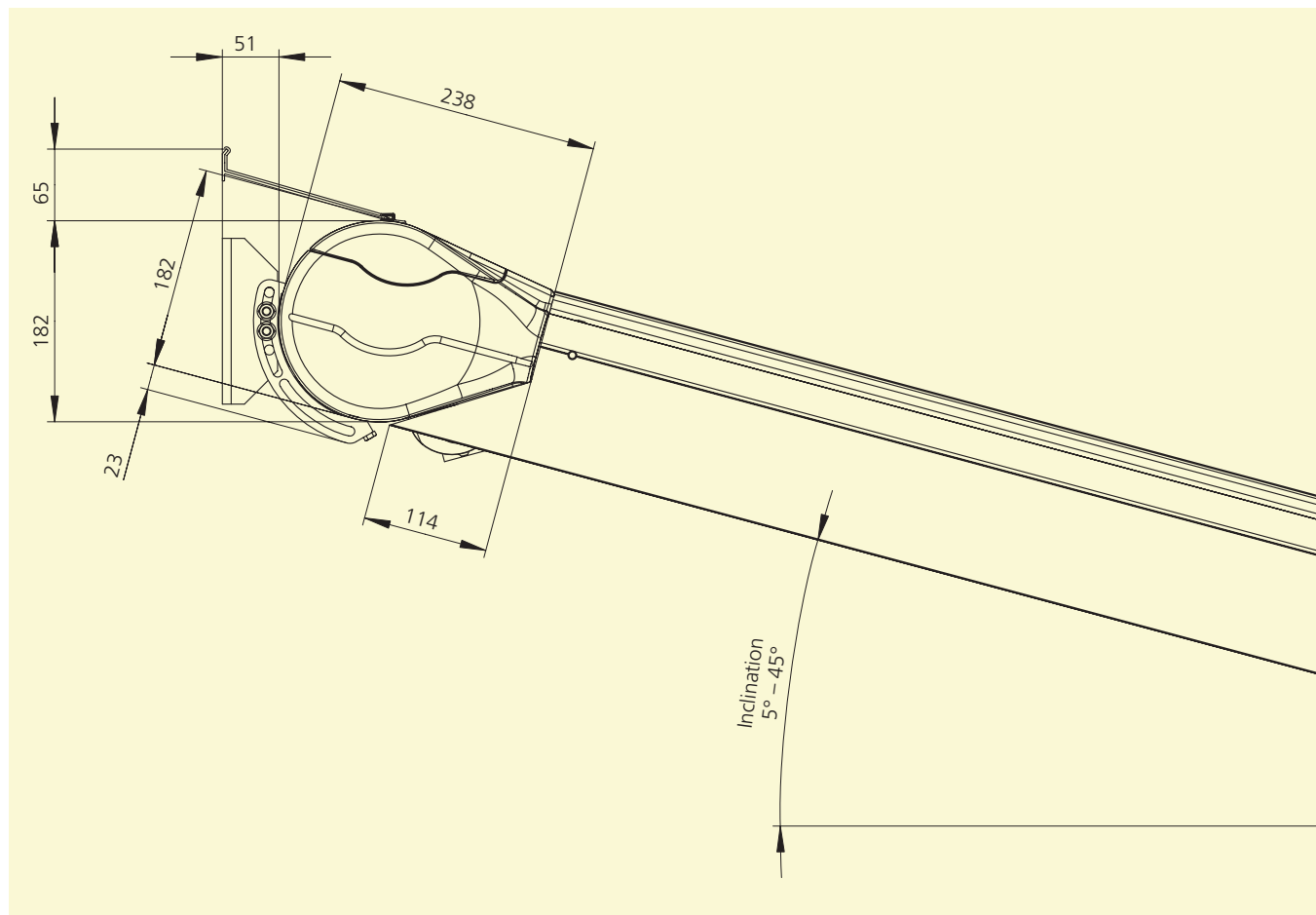

We reserve the right to make technical alterations. May 2009

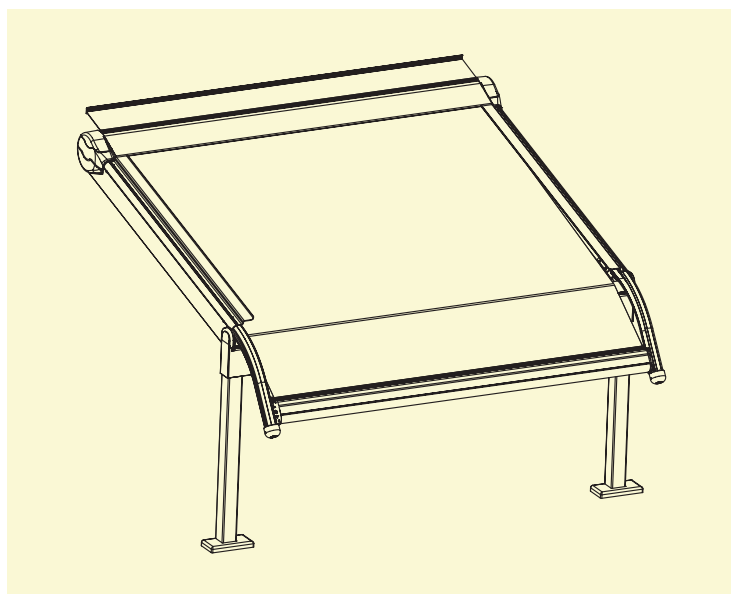



## Calculating dimensions for weinor Plaza Pro with GEs

**Table for quick overview of ratio between depth of patio T and inclination NW and showing the resulting assembly height AH and projection length B**  
Clearance height 210 cm (DH)

| Inclination<br>(°) | Depth of patio T (values given in cm) |     |         |     |         |     |         |     |         |     |         |     |         |     |         |     |         |     |
|--------------------|---------------------------------------|-----|---------|-----|---------|-----|---------|-----|---------|-----|---------|-----|---------|-----|---------|-----|---------|-----|
|                    | T = 100                               |     | T = 150 |     | T = 200 |     | T = 250 |     | T = 300 |     | T = 350 |     | T = 400 |     | T = 450 |     | T = 500 |     |
|                    | AH                                    | B   | AH      | B   | AH      | B   | AH      | B   | AH      | B   | AH      | B   | AH      | B   | AH      | B   | AH      | B   |
| 5                  |                                       |     | 242     | 196 | 246     | 247 | 251     | 297 | 255     | 347 | 260     | 397 | 264     | 447 | 268     | 498 | 273     | 548 |
| 6                  |                                       |     | 245     | 197 | 250     | 247 | 255     | 297 | 260     | 348 | 266     | 398 | 271     | 448 | 276     | 498 | 281     | 549 |
| 7                  |                                       |     | 247     | 197 | 253     | 247 | 259     | 298 | 265     | 348 | 272     | 399 | 278     | 449 | 284     | 499 | 290     | 550 |
| 8                  |                                       |     | 249     | 197 | 257     | 248 | 264     | 298 | 271     | 349 | 278     | 399 | 285     | 450 | 292     | 500 | 299     | 551 |
| 9                  |                                       |     | 252     | 198 | 260     | 249 | 268     | 299 | 276     | 350 | 284     | 400 | 292     | 451 | 299     | 502 | 307     | 552 |
| 10                 |                                       |     | 254     | 198 | 263     | 249 | 272     | 300 | 281     | 351 | 290     | 402 | 299     | 452 | 307     | 503 | 316     | 554 |
| 11                 |                                       |     | 257     | 199 | 267     | 250 | 276     | 301 | 286     | 352 | 296     | 403 | 306     | 454 | 315     | 505 | 325     | 556 |
| 12                 |                                       |     | 260     | 200 | 270     | 251 | 281     | 302 | 291     | 353 | 302     | 404 | 313     | 455 | 323     | 506 | 334     | 557 |
| 13                 |                                       |     | 262     | 200 | 274     | 252 | 285     | 303 | 297     | 354 | 308     | 406 | 320     | 457 | 331     | 508 | 343     | 559 |
| 14                 |                                       |     | 265     | 201 | 277     | 252 | 290     | 304 | 302     | 356 | 315     | 407 | 327     | 459 | 340     | 510 | 352     | 562 |
| 15                 | 254                                   | 150 | 267     | 202 | 281     | 253 | 294     | 305 | 308     | 357 | 321     | 409 | 334     | 461 | 348     | 512 | 361     | 564 |
| 16                 | 256                                   | 150 | 270     | 203 | 284     | 255 | 299     | 307 | 313     | 359 | 327     | 411 | 342     | 463 | 356     | 515 | 370     | 567 |
| 17                 | 257                                   | 151 | 273     | 203 | 288     | 256 | 303     | 308 | 319     | 360 | 334     | 413 | 349     | 465 | 364     | 517 | 380     | 569 |
| 18                 | 259                                   | 152 | 275     | 204 | 292     | 257 | 308     | 309 | 324     | 362 | 340     | 415 | 357     | 467 | 373     | 520 | 389     | 572 |
| 19                 | 261                                   | 152 | 278     | 205 | 295     | 258 | 313     | 311 | 330     | 364 | 347     | 417 | 364     | 470 | 381     | 523 | 399     | 575 |
| 20                 | 263                                   | 153 | 281     | 206 | 299     | 259 | 317     | 313 | 335     | 366 | 354     | 419 | 372     | 472 | 390     | 526 | 408     | 579 |
| 21                 | 264                                   | 154 | 284     | 207 | 303     | 261 | 322     | 314 | 341     | 368 | 360     | 422 | 380     | 475 | 399     | 529 | 418     | 582 |
| 22                 | 266                                   | 155 | 287     | 208 | 307     | 262 | 327     | 316 | 347     | 370 | 367     | 424 | 388     | 478 | 408     | 532 | 428     | 586 |
| 23                 | 268                                   | 155 | 289     | 210 | 311     | 264 | 332     | 318 | 353     | 373 | 374     | 427 | 396     | 481 | 417     | 536 | 438     | 590 |
| 24                 | 270                                   | 156 | 292     | 211 | 315     | 266 | 337     | 320 | 359     | 375 | 381     | 430 | 404     | 485 | 426     | 539 | 448     | 594 |
| 25                 | 272                                   | 157 | 295     | 212 | 319     | 267 | 342     | 323 | 365     | 378 | 389     | 433 | 412     | 488 | 435     | 543 | 459     | 598 |
| 26                 | 274                                   | 158 | 298     | 214 | 323     | 269 | 347     | 325 | 372     | 381 | 396     | 436 | 420     | 492 | 445     | 547 | 469     | 603 |
| 27                 | 276                                   | 159 | 301     | 215 | 327     | 271 | 352     | 327 | 378     | 383 | 403     | 440 | 429     | 496 | 454     | 552 |         |     |
| 28                 | 278                                   | 160 | 305     | 217 | 331     | 273 | 358     | 330 | 384     | 387 | 411     | 443 | 438     | 500 | 464     | 556 |         |     |
| 29                 | 280                                   | 161 | 308     | 218 | 336     | 275 | 363     | 333 | 391     | 390 | 419     | 447 | 446     | 504 | 474     | 561 |         |     |
| 30                 | 282                                   | 162 | 311     | 220 | 340     | 278 | 369     | 335 | 398     | 393 | 427     | 451 | 455     | 509 | 484     | 566 |         |     |
| 31                 | 284                                   | 163 | 314     | 222 | 344     | 280 | 375     | 338 | 405     | 397 | 435     | 455 | 465     | 513 | 495     | 572 |         |     |
| 32                 | 287                                   | 165 | 318     | 224 | 349     | 283 | 380     | 342 | 412     | 401 | 443     | 459 | 474     | 518 | 505     | 577 |         |     |
| 33                 | 289                                   | 166 | 321     | 226 | 354     | 285 | 386     | 345 | 419     | 404 | 451     | 464 | 484     | 524 | 516     | 583 |         |     |
| 34                 | 291                                   | 167 | 325     | 228 | 359     | 288 | 392     | 348 | 426     | 409 | 460     | 469 | 494     | 529 | 527     | 590 |         |     |
| 35                 | 294                                   | 169 | 329     | 230 | 364     | 291 | 399     | 352 | 434     | 413 | 469     | 474 | 504     | 535 | 539     | 596 |         |     |
| 36                 | 296                                   | 170 | 332     | 232 | 369     | 294 | 405     | 356 | 441     | 418 | 478     | 479 | 514     | 541 | 550     | 603 |         |     |
| 37                 | 298                                   | 172 | 336     | 234 | 374     | 297 | 411     | 360 | 449     | 422 | 487     | 485 | 525     | 548 |         |     |         |     |
| 38                 | 301                                   | 174 | 340     | 237 | 379     | 300 | 418     | 364 | 457     | 427 | 496     | 491 | 535     | 554 |         |     |         |     |
| 39                 | 304                                   | 175 | 344     | 240 | 385     | 304 | 425     | 368 | 466     | 433 | 506     | 497 | 547     | 561 |         |     |         |     |
| 40                 | 306                                   | 177 | 348     | 242 | 390     | 308 | 432     | 373 | 474     | 438 | 516     | 503 | 558     | 569 |         |     |         |     |
| 41                 | 309                                   | 179 | 353     | 245 | 396     | 312 | 440     | 378 | 483     | 444 | 527     | 510 | 570     | 577 |         |     |         |     |
| 42                 | 312                                   | 181 | 357     | 248 | 402     | 316 | 447     | 383 | 492     | 450 | 537     | 517 | 582     | 585 |         |     |         |     |
| 43                 | 315                                   | 183 | 362     | 251 | 408     | 320 | 455     | 388 | 502     | 457 | 548     | 525 | 595     | 593 |         |     |         |     |
| 44                 | 318                                   | 185 | 366     | 255 | 415     | 324 | 463     | 394 | 511     | 463 | 560     | 533 | 608     | 602 |         |     |         |     |
| 45                 | 321                                   | 188 | 371     | 258 | 421     | 329 | 471     | 400 | 521     | 471 | 571     | 541 |         |     |         |     |         |     |

- Maximum projection length B = 600 cm
- Minimum projection length B = 150 cm
- A strengthening profile must be used when B = 400 cm or more

Borderline cases for warranty